

**SATURATOR**

**SP-800-M-095**

**Rev. 0**

**05/08/00**

**Page 1 of 1**

Service: Cool filtered Baghouse gases to brine saturation temperature (approx. 175 °F)

Size: Overall Vessel Height : 15' 3" high  
 Top Inverted Conical Section: 6" long x 84" I.D. x 105" I.D.  
 Cylindrical Section: 6" long x 105" I.D.  
 Second Conical Section: 31" long x 105" I.D. x 64" I.D.  
 Cylindrical Section: 64" I.D. x 11' 2" long

Contacting Device: Sprays located near top. Axial: 12; 4 normally used

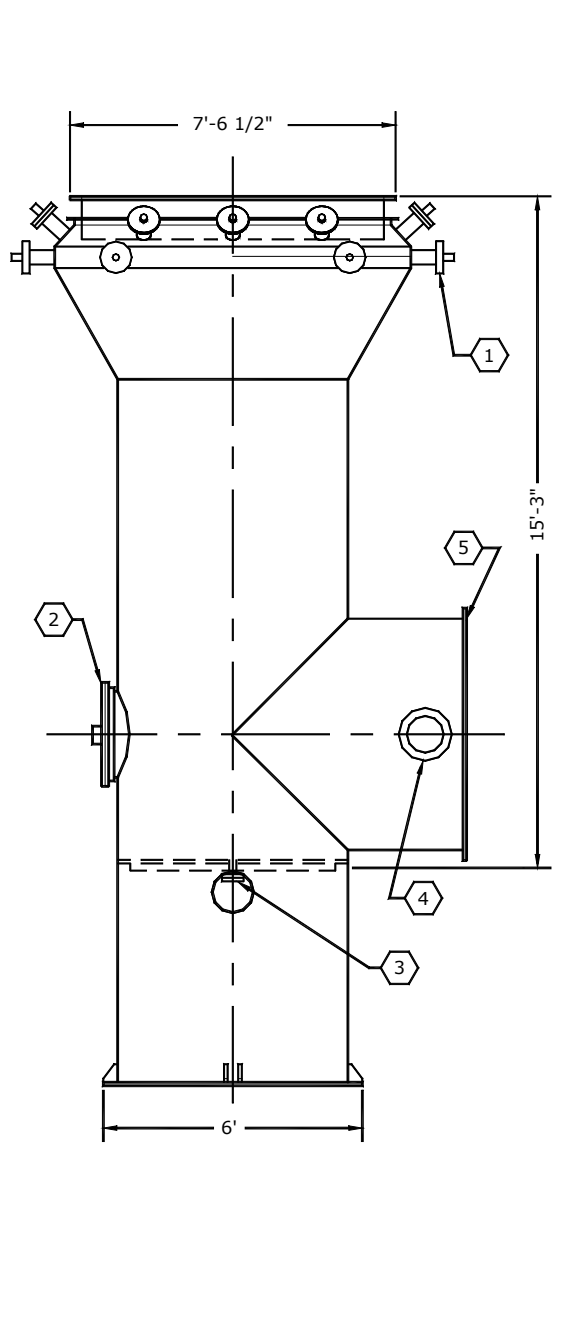

**Vessel – Operating and Mechanical Conditions**

Design Pressure: -30 to +12" W.C.  
 Design Gas Inlet temp: min 350 °F; max 600 °F  
 Material: mild steel  
 Lining: High Temperature Fiberglass  
 Liquid Supply: design 300 GPM  
 Hastelloy splash shield in vessel above top sprays

**Spray Nozzles**

Top Row:  
 1 ½" Cone Spray Alloy 20 or equal  
 Bottom Row:  
 1 ½" Flat Spray Alloy 20 or equal

**Nozzles**

Service	Number	Description	Mark
Spray Nozzles	12	3"	1
Mandoor	1	24"	2
Drain	1	2"	3
Fire Prevention	1	10"	4
Outlet	1	64"	5